

CIW120

The world's most advanced rolled wipes canisters capper

Specifically designed for nonwovens rolled wipes canisters, a part of our first-class Rolled Wipes Downstream Series, the versatile CIW120 is designed to accurately and fully automatically apply round, oval or rectangular caps on canisters with multiple orientations per product. The CIW120 has sub 20 minutes tool less changeover, a lids-deformation prevention mechanism and a throughput of 120-130 canisters per minute (up to 200ppm models available).



Quick Fact Sheet:

- Fully automatic
- Speed: 120-130 canisters per minute
- Also available: CIW60 for speeds of 50-60 per minute, CIW150 for 140-150 per minute and CIW200 for 190-200 per minute
- Seamlessly synchronized with the rest of the Rolled Wipes Downstream Equipment Series
- Applicable to most canister lids existing in the market
- Sanitary design for highest standards of rolled wipes production
- Easy and fast to clean, change for different product sizes setup and maintain
- Explosion proof, corrosion proof upgrades available
- Supporting both oval, conic, round and rectangular canisters
- Built in quality control & defects reject system
- Multiple orientations available - canister direction, canister to lid, lid to canister and more
- Industry 4.0 ready



Explosion Proofed & Corrosion Proofed Equipment Upgrades



Corrosive or alcohol-based solutions dictate that your equipment is duly fitted to professionally handle these delicate environments. Years of experience in the field made it possible for us to tailor you the exact protection so your production is safe and stable, while your people and equipment are well protected, keeping your facility at the top of the range.

All of our machines are constructed using SST 304/316L, and are available with anti corrosive proprietary coating. As well as the machine base, all vital parts such as nozzles and pumps are also specially treated.

For more information, please contact your regional Shemesh Automation Representative.



Built in ATEX rated commended ventilation systems for flammable fumes evacuation



EX Approved Components such as SIEMENS motors, BANNER Sensors and SIEMENS PLC and HMIs

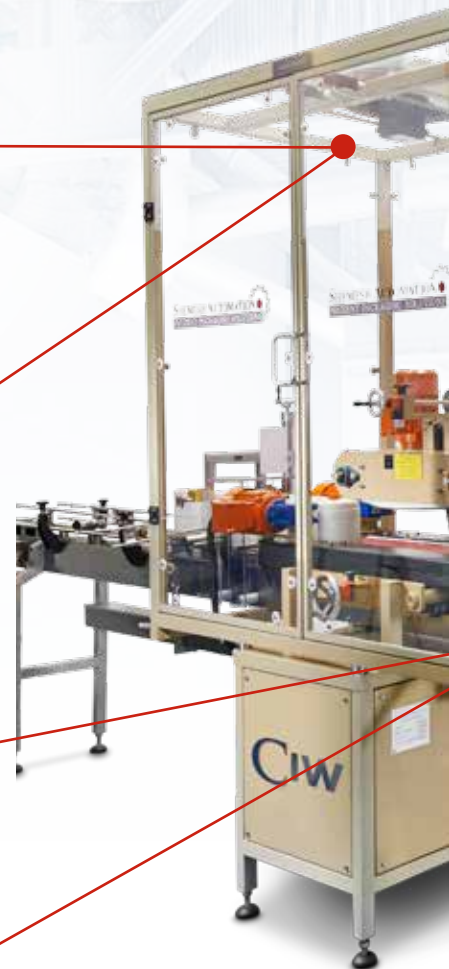



ANTI CORROSION



Clean Machine Finishing



BANNER Sensors

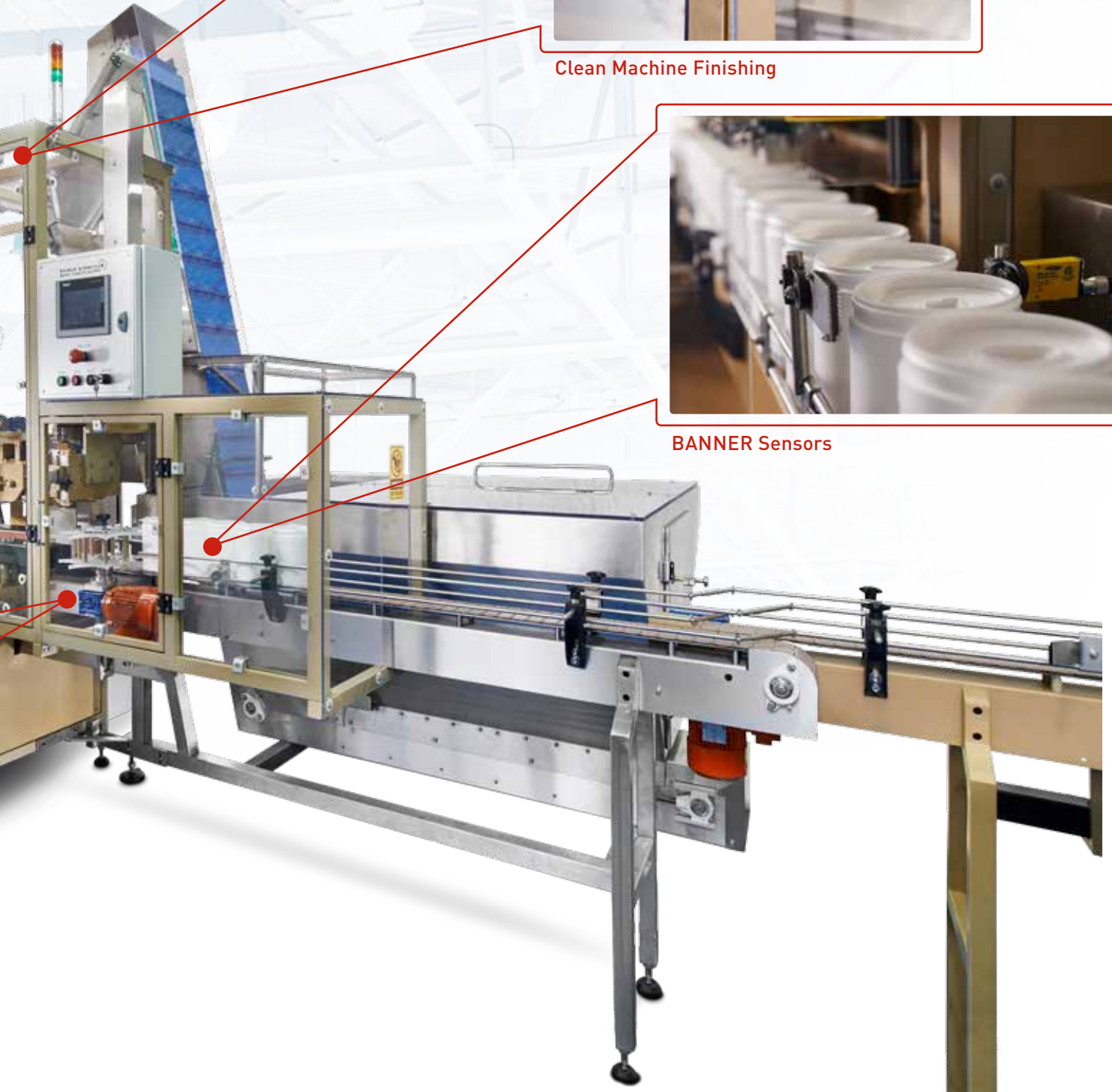

The CIW



Top view

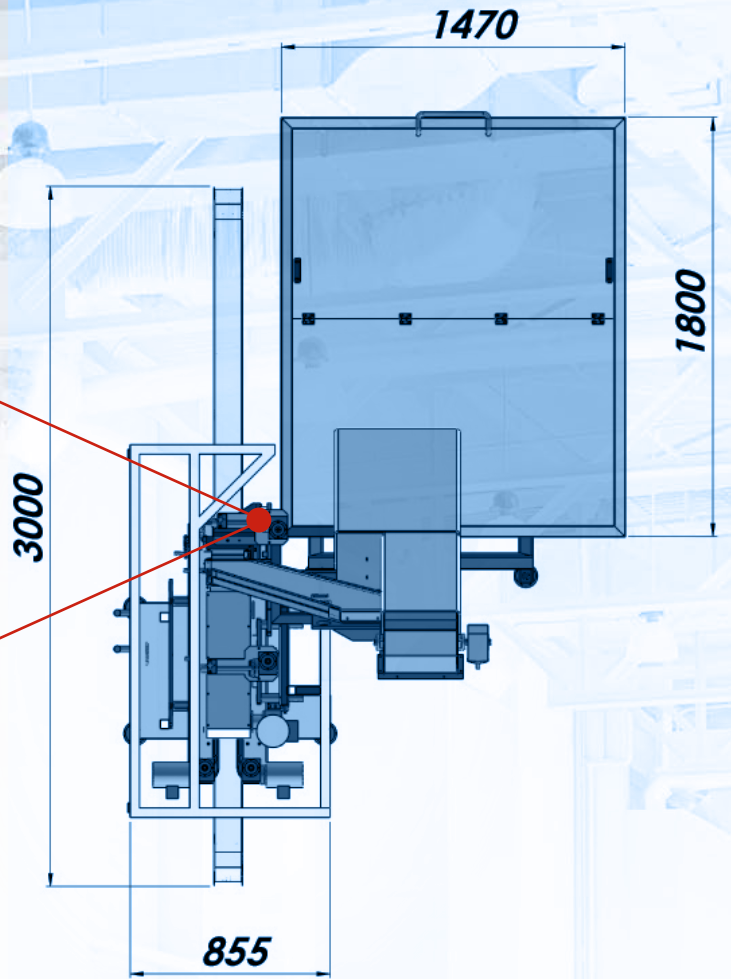

Side view

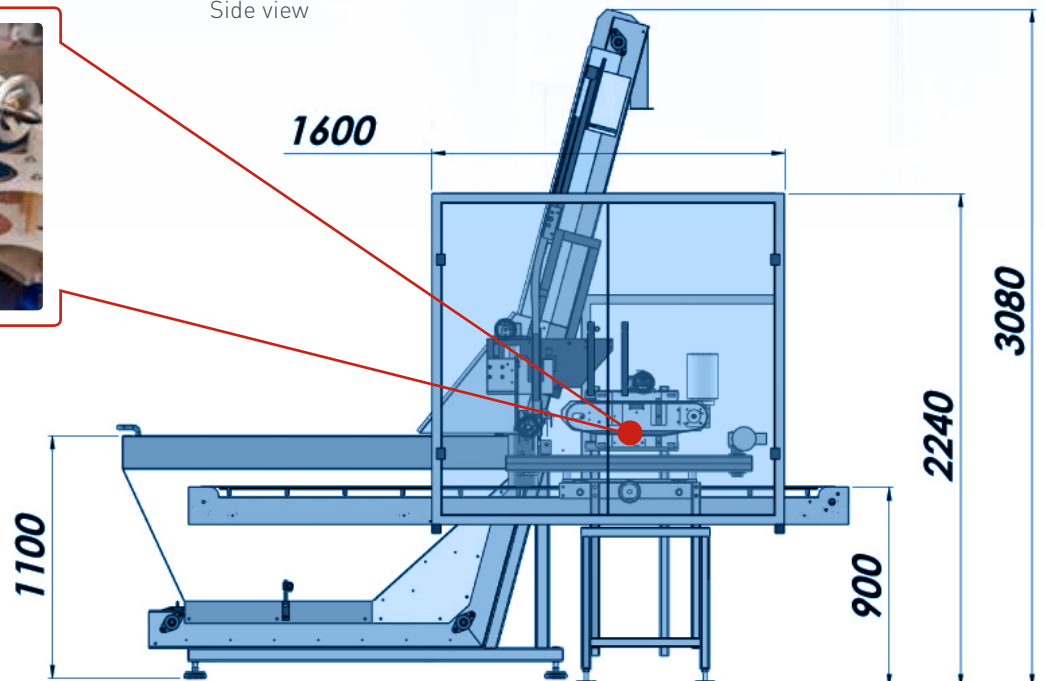



For a video demo
visit us at:
sawetwipes.com

Machine specifications:

Lids

Lids Diameter	Min: 75mm	Max: 130mm
Lids Hopper	<ul style="list-style-type: none">• Volume: 300L. Contains 4000 lids (80mm diameter size)• Material: stainless steel SST304• Top cover made of polycarbonate• Level transmitters: half full, empty.• Dimensions: W. 1.5m, L. 1.8m, H. 1.1m• Opening doors for easy access	

Throughput

Products per minute	120-130 (up to 200ppm models available)
---------------------	---

Other Features

Capping Method	Snap-on and/or Screw and/or Twist-off
Anti deformation Mechanism	Shemesh Automation designed mechanism to prevent canister lids from deforming during the capping process
Star Wheel/ Screw Canisters Feeding	Indexing, forwarding and counting canisters
Rotation handle	User friendly and quick canisters height adjustment tool (no additional setup parts required)

Machine Construction

Main chain conveyor (made of stainless steel SST304)	Length: 315cm	Width: 100mm
Machine frame and body made of stainless steel SST304	RHS 40x80	

Machine Control

Safety controls, emergency stop & doors	Wired through Category 4 Compliant Controller	
Color HMI Touch Panel	ALLEN BRADLEY or SIEMENS options are available	
PLC	ALLEN BRADLEY or SIEMENS options are available	
Sensors	OMRON, SICK or BANNER	
Voltage	Europe: 3X380V, 1.5KWH	US: 460/480, 3P, 50/60, 6A or 280, 3P, 1.5KWH
Pneumatics	FESTO / SMC	
Air Supply	6ATM, 0.124 CFM, 3.5 Litre/Minute	

Machine Dimensions:

	Height: 3080mm	Width: 3150mm	Depth: 2000mm
Machine Weight	1100 KG		

The World's Premier Manufacturer of Round Wipes Downstream Equipment

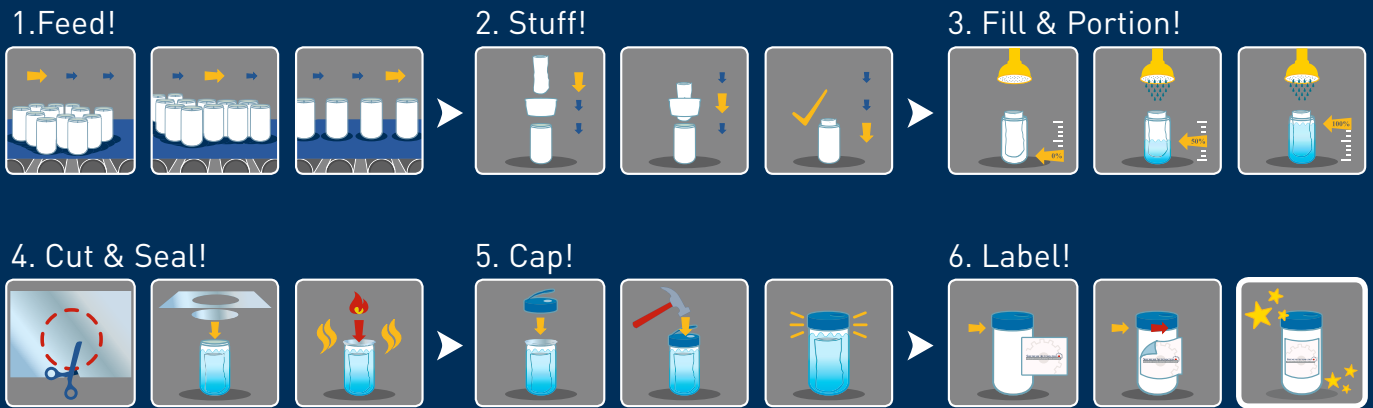

REGIONAL HEADQUARTERS

United Kingdom

Shemesh Automation UK Ltd
Contact: Mr. Andrew Hayward

North America

Shemesh USA Inc
Contact: Mr. Jim Livermore
Shemesh Automation Wet Wipes
Contact: Mr. Jim Livermore

France

Shemesh Automation France
Contact: Ms. Nelly Desbiens

Israel

Shemesh Automation Israel Ltd
Contact: Mr. Luis Coronel

OTHER OFFICES

Spain

Shemesh Spain
Contact: Mr. Joaquim Julve

United Arab Emirates

Shemesh Automation UAE
Contact: Mr. Johann Van Niekerk

South Africa

Shemesh Automation SA
Contact: Mr. Simon Daniels

India

Shemesh Automation India
Contact: Mr. Shilpan Patel

China & Hong Kong

Shemesh Automation Asia
Contact: Mr. Charles Yip

Japan & Indonesia

Shemesh Automation Japan & Indonesia
Contact: Mr. Kentaro Taguchi

Australia & New Zealand

Shemesh Automation Australia & New Zealand
Contact: Mr. Cameron McKenzie

LATIN AMERICA

Contact: Mr. Nir Baram



GLOBAL SALES

Contact: Mr. Luis Coronel

For all sales enquiries please contact us via sales@shemeshautomation.com



For FREE advice and demo videos:

-  Shemesh Automation UK. Tel. +44 758 428 1707
-  Shemesh Automation USA, Tel. +1 920 325 0050
-  Shemesh Automation Israel. Tel. +972 3550 9946
-  Shemesh Automation France, Tel. +33 6 15 21 04 09

Sales@shemeshautomation.com
www.sawetwipes.com



"Great product, great team! Shemesh delivered a turnkey production line as promised under extraordinary circumstances during the pandemic. We would certainly consider partnering with them again in the future and highly recommend their products and services."

Jason Slosberg, MD Founder
Business Lead Legacy Converting, Inc (Everwipe)

