

FGW120

The world's most advanced round wipes wetting and portioning machine

The FGW120 is a top of the range positive displacement linear dosing & filling design made specifically for the wetting process of nonwoven rolls in canisters. It is easily adjusted to fill various volumes with high range of viscosities. And in addition to under 20 minutes toolless changeover time, the FGW120 boasts proprietary screwless showerhead nozzles with no-drip, no overflow engineering that delivers a staggering homogenous and effective liquid absorption. Each FGW120 filling station has its own gear pump and encoder, giving it a filling tolerance that is only +/-3ml(!) of volume. The FGW120 is industry 4.0 ready, fully controlled from the SIEMENS HMI, has a built-in CIP and a smart liquid tank.

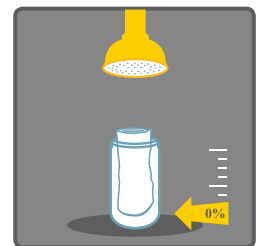

Quick Fact Sheet:

- Fully automatic
- Throughput models offered: 60, 120 & 200 products per minute
- Portioning tolerance: +/-3ml(!) of filling volume, **reducing waste!**
- Sub 20 minutes changeover, **reducing downtime!**
- Anti-overflow proprietary mechanism
- Anti-drip proprietary ultra wide screwless shower nozzles
- Supporting both oval, conic, round and rectangular canisters
- Sanitary design for highest standards of rolled wipes production
- Explosion proof, corrosion proof upgrades available
- All machine metals are Stainless Steel 304 or 316 where liquid flows
- Electro-polished Smart liquid tank
- Built in CIP
- Industry 4.0 ready



Explosion Proofed & Corrosion Proofed Equipment Upgrades



Corrosive or alcohol-based solutions dictate that your equipment is duly fitted to professionally handle these delicate environments. Years of experience in the field made it possible for us to tailor you the exact protection so your production is safe and stable, while your people and equipment are well protected, keeping your facility at the top of the range.

All of our machines are constructed using SST 304/316L, and are available with anti corrosive proprietary coating. As well as the machine base, all vital parts such as nozzles and pumps are also specially treated.

For more information, please contact your regional Shemesh Automation Representative.



EX Approved Components such as SIEMENS motors, BANNER Sensors and SIEMENS PLC and HMIs

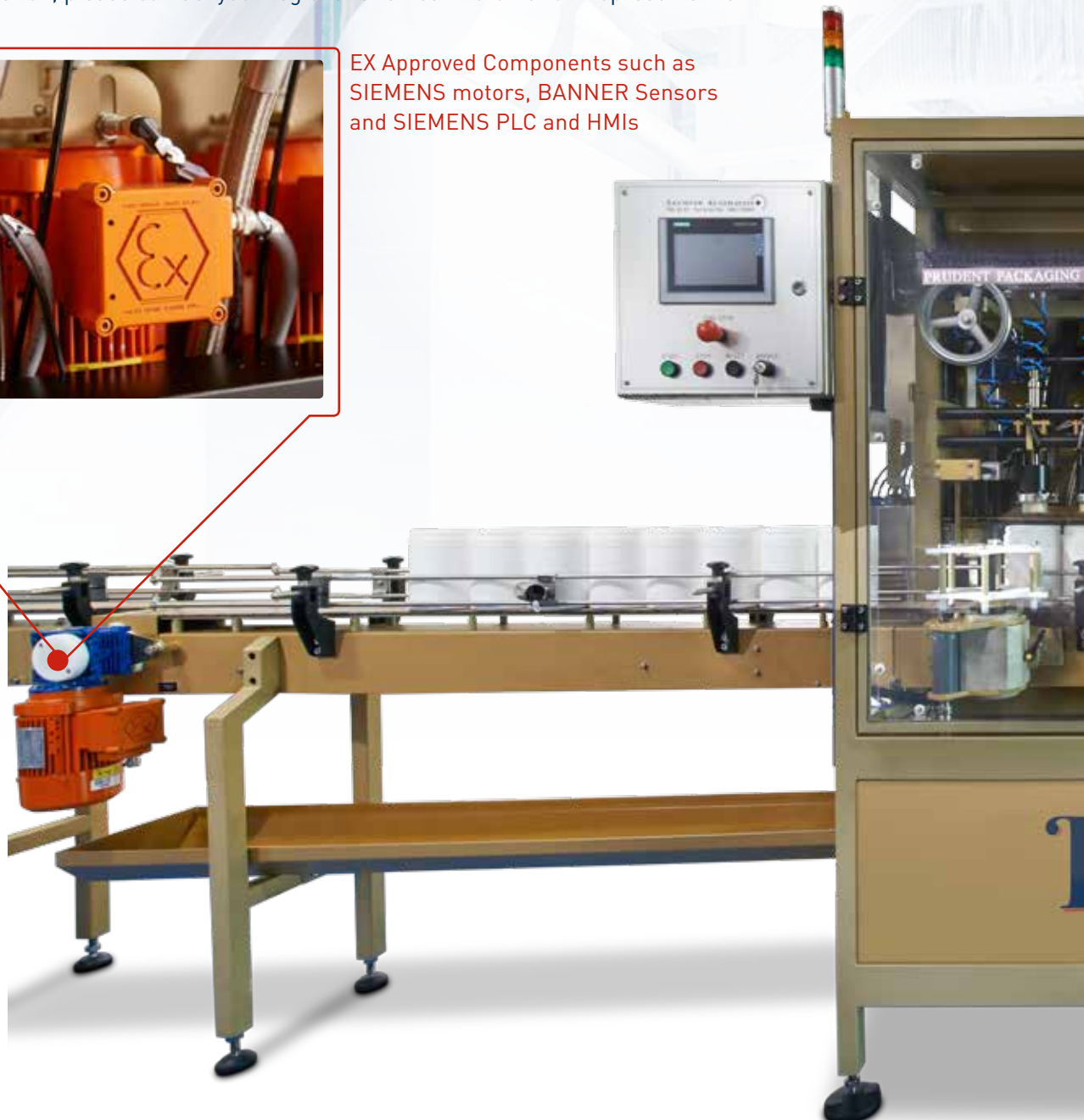



ANTI CORROSION



Built in ATEX rated commended ventilation systems for flammable fumes evacuation

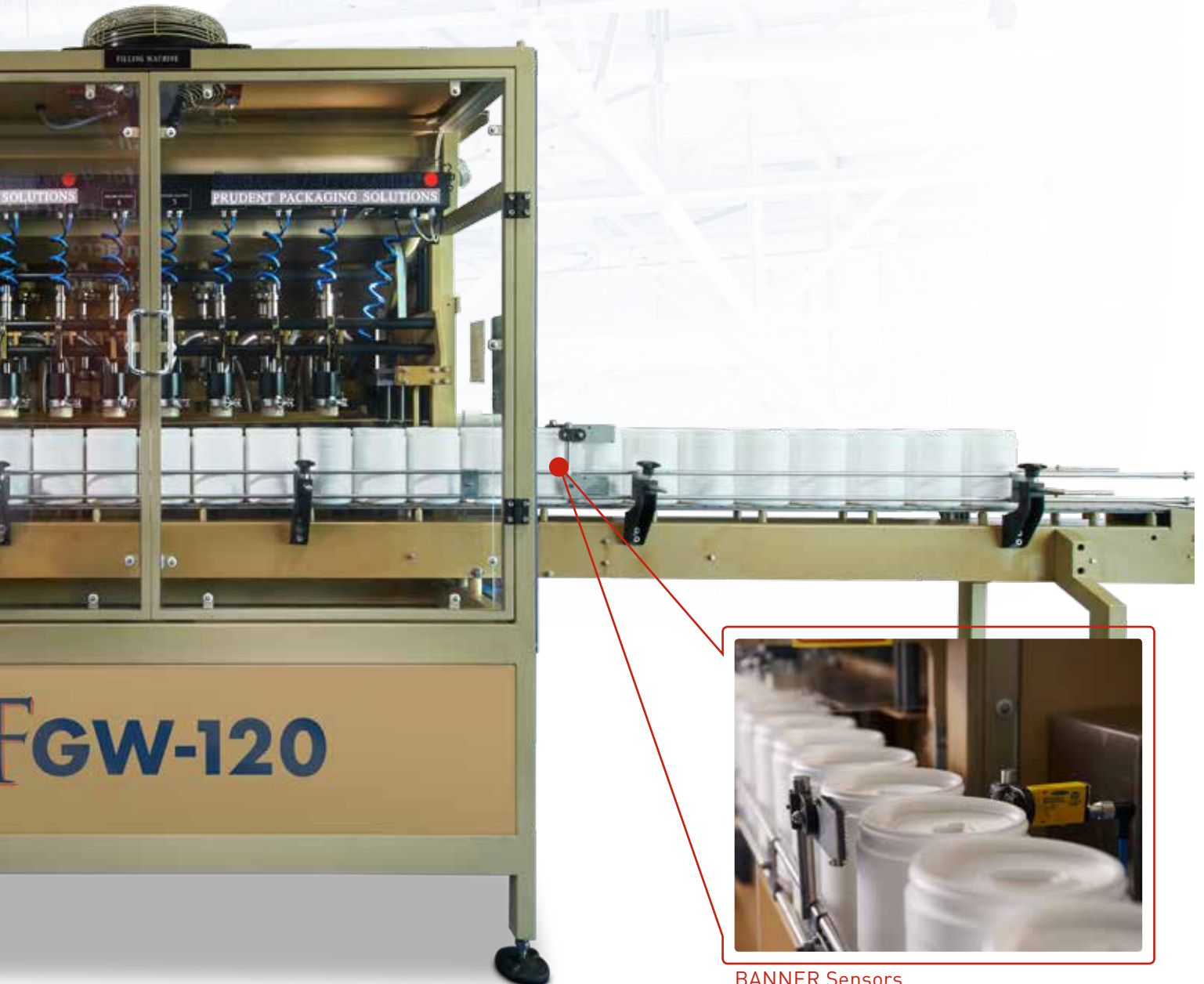

BANNER Sensors

The FGW210

THE FGW120 IS GEAR PUMPS EQUIPPED

Main pros vis-à-vis volumetric, gravity or piston fillers are:

- **Fill Range:** filling volume range is theoretically unlimited.
- **Control:** portioning volume and speed tuning and fine-tuning are fast and easy via the Machine's HMI.
- **Automatic dosing** and positive displacement pumps filling.
- **Accuracy:** portioning tolerance within a mere +/-3ml(!) of volume. Saving waste!
- **Sanitation:** inherently cleaner than most other methodologies existing in the market.
- **Space:** fewer pumps are required for the same filling volume, saving space!
- **User friendly:** filling volume and throughput is controlled for either all or each pump with no-tools through the HMI interface (impossible with volumetric filler).
- **Maintenance:** is easier to do and less expensive.
- **Reliability:** this methodology is the most reliable and cost effective over time.

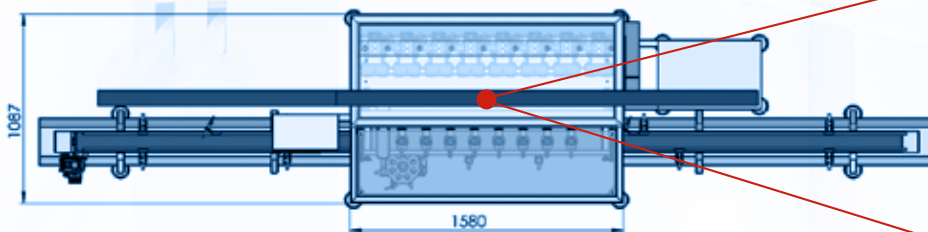

Top view



FDA-approved pipes and piping works, screw-less engineering and tri-clamps fittings



Tool-less sub 20 minutes changeover.
Sanitary and robust design. Accurate and consistent production.

Side view

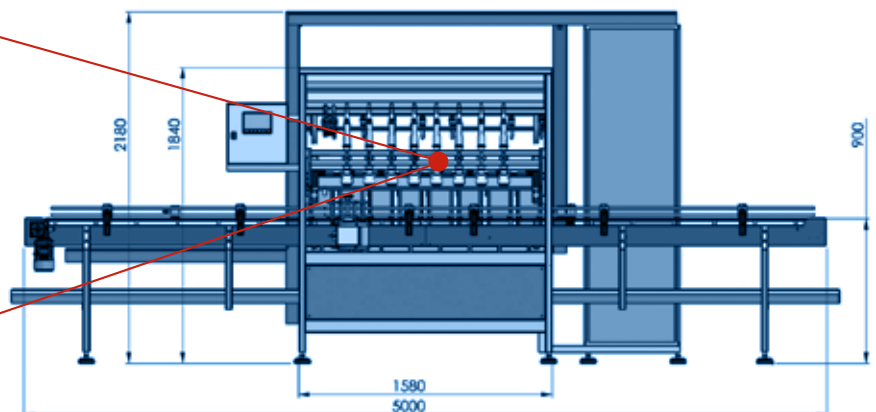

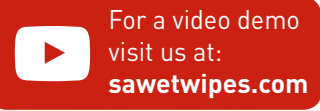

Machine specifications:

Canister

Canister Dimensions Supported	Diameter		Height	
	Min: 75mm	Max:130mm	Min:100mm	Max:280mm
Canisters shape supported	Round, oval, conic and rectangular			
Canisters per filling cycle	8 (optional up to 10)			
Throughput	120 per minute given 450ml - 500ml of filling volume per canister			

Other Features

Filling range capacity, per canister	25cc - 10L
Filling viscosity supported	Up to 60,000 centipoise
Filling tolerance	+/-3ml(!) of volume, reducing waste!
Filling temperature	Applicable for hot liquids up to 95° Celsius
Changeover time	Sub 20 minutes, tools-free, reducing downtime!
Filling Method	8 independent SST316 Special Shemesh Automation Gear Pumps controlled individually or as a unit through a smart touch screen
Encoder equipped Screwless Nozzles	Shemesh Automation unique ultra wide no-drip showerhead, Teflon, PDMA or Viton seals equipped screwless nozzles for optimal absorbance and round rolls liquid dispersion
Star wheel/ Screw Canisters Feeding	Indexing, forwarding and counting canisters
Smart Liquid Tank	Made of Electropolished SST316 stainless steel, 2 level transmitters (half full and empty). Volume: 115L
Built in CIP	Automatic hot liquid flush mode, built-in spray balls, hermetically sealed smart tank
Liquid Bath	Featured as a tunnel running under the machine base and conveyor to contain excess liquids. Made of SST304 stainless steel
Drip Tray	Installed inside the machine body, made of SST316 stainless steel. Enabled/disabled touch screen control

Machine Construction

Main Conveyor (made from SST304)	Length: 5m	Width: 130mm
Machine frame (made from SST304/316L)	RHS 40x80	

Machine Control

Safety controls, emergency stop & doors	Wired through Category 4 Compliant Controller	
Color HMI Touch panel	ALLEN BRADLEY or SIEMENS options are available	
PLC	ALLEN BRADLEY or SIEMENS options are available	
Sensors	OMRON, SICK or BANNER	
Voltage	Europe: 3X380V, 2KWH	US: 460/480, 3P, 50/60, 6A or 280, 3P, 2KWH
Pneumatics	FESTO/SMC	
Air Supply	6ATM, 0.06CFM, 1.67 Litre/Minute	

Machine Dimensions:

	Height:1800mm	Width:5172mm	Depth:1087mm
Machine Weight	600 KG		

The World's Premier Manufacturer of Round Wipes Downstream Equipment

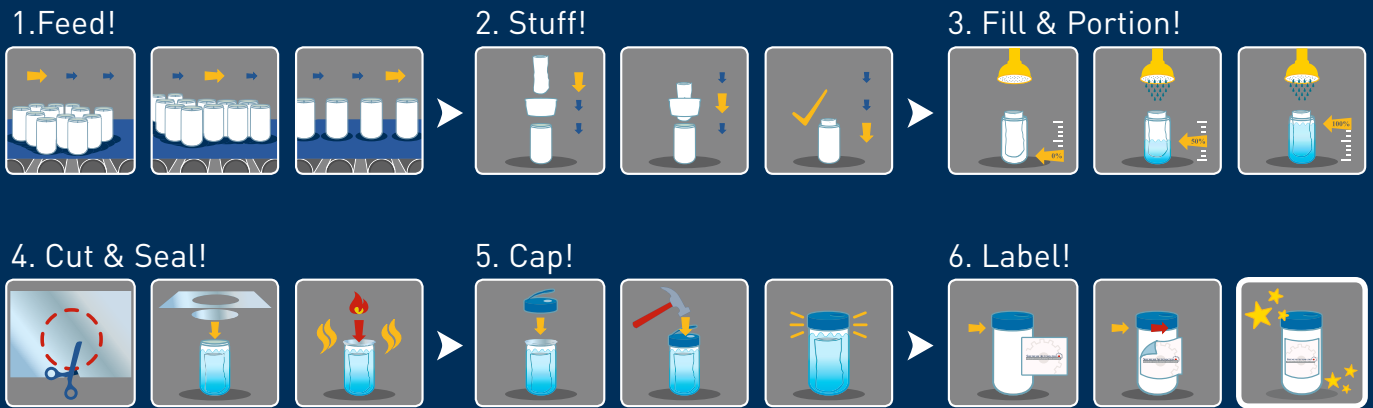

REGIONAL HEADQUARTERS

United Kingdom

Shemesh Automation UK Ltd
Contact: Mr. Tony Bryant

North America

Shemesh USA Inc
Contact: Mr. Bob Green
Shemesh Automation Wet Wipes
Contact: Mr. Mark Calliari

France

Shemesh Automation France
Contact: Mr. Jean-Philippe Henriot

Israel

Shemesh Automation Israel Ltd
Contact: Mr. Yonatan Levy

OTHER OFFICES

Spain

Shemesh Spain
Contact: Mr. Joaquim Julve

United Arab Emirates

Shemesh Automation UAE
Contact: Mr. Johann Van Niekerk

South Africa

Shemesh Automation SA
Contact: Mr. Simon Daniels

India

Shemesh Automation India
Contact: Mr. Shilpan Patel

China & Hong Kong

Shemesh Automation Asia
Contact: Mr. Charles Yip

Japan & Indonesia

Shemesh Automation Japan & Indonesia
Contact: Mr. Kentaro Taguchi

Australia & New Zealand

Shemesh Automation Australia & New Zealand
Contact: Mr. Cameron McKenzie

LATIN AMERICA

Contact: Mr. Nir Baram

GLOBAL SALES

Contact: Mr. Yonatan Levy

For all sales enquiries please contact us via sales@shemeshautomation.com



For FREE advice and demo videos:

- Shemesh Automation UK. Tel. +44 7927 840 176
- Shemesh Automation USA, Tel. +1 443 761 8744
- Shemesh Automation Israel. Tel. +972 3550 9946
- Shemesh Automation France, Tel. +33 (0)611 577 504

Sales@shemeshautomation.com
www.sawetwipes.com



"Great product, great team! Shemesh delivered a turnkey production line as promised under extraordinary circumstances during the pandemic. We would certainly consider partnering with them again in the future and highly recommend their products and services."

Jason Slosberg, MD Founder
Business Lead Legacy Converting, Inc (Everwipe)

